

BLINK SOLAR

How many points are connected to the grid for the Port Louis solar container communication station inverter

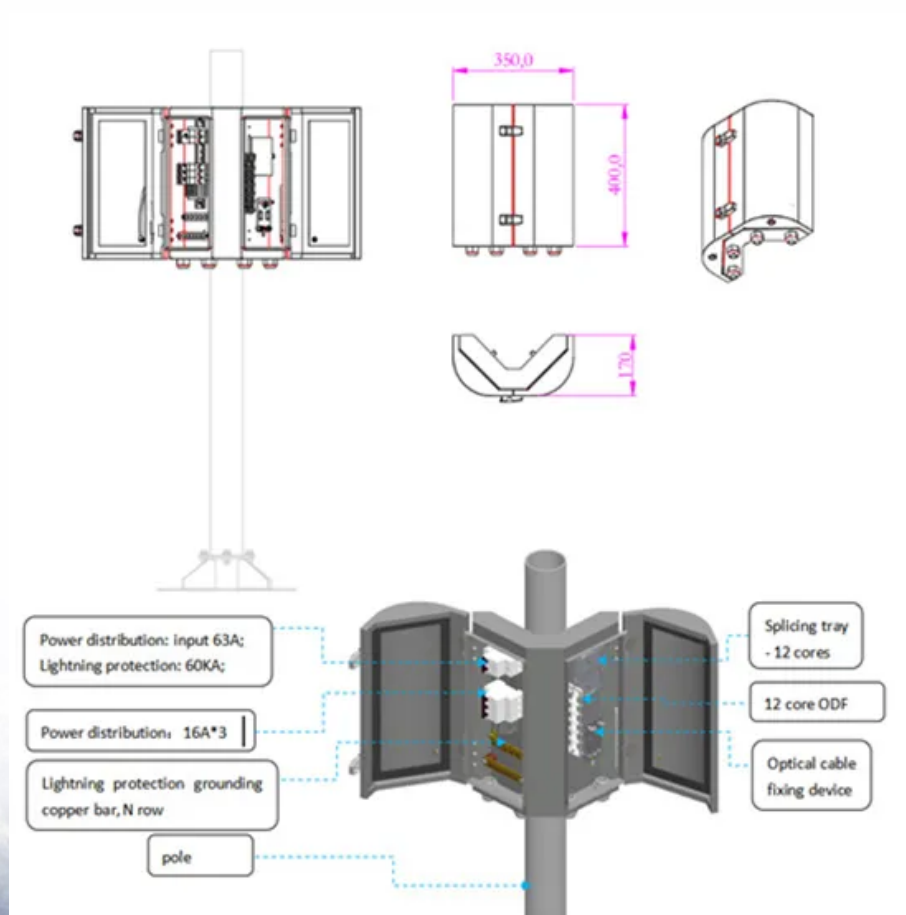

Overview

What is a solar power interconnection (POI)?

In utility scale in solar projects, the POI is a point of interconnection for clean energy into the grid. A well-integrated POI means that the project is set to operate within the set requirements and provisions, operate safely and provide power effectively.

Do solar farms need a point of interconnection (POI)?

Without a POI, the modern solar farms still cannot supply power to the electric grid. It is an essential part of a solar setup that guarantees smooth flow of power in the system. The base of a utility scale solar project is a well-designed Point of Interconnection (POI).

What is a point of interconnection for solar?

Location: The point of interconnection for solar can be at the main service panel (for residential or commercial systems) or at a utility substation (for larger-scale solar farms). Grid Connection: At the POI, the AC power generated by the solar system (after being converted from DC by the inverter) is synchronized with the grid.

How to connect a PV system to a grid?

The steps to connect these systems to the systems required follow these steps: Interconnection of PV modules. Connection of modules to power inverters. Connection of the power to the grid point. In each facility, we must install an interconnection panel with the grid.

How many points are connected to the grid for the Port Louis solar



The Point of Interconnection (POI) in Utility-Scale Solar ...

In utility scale in solar projects, the POI is a point of interconnection for clean energy into the grid. A well-integrated POI means that the project is set to operate within the ...

Solar Interconnection: How Solar Farms Connect to the Grid

Solar interconnection is critical for commercial solar projects to connect to the power grid and earn compensation for electricity generated from distributed generation. ...



Utility Interconnection for Solar Projects: What to Know

In commercial and utility-scale solar projects, utility interconnection is one of the most critical steps in transitioning a completed system from construction to operation. Without ...

How Does a Solar Farm Connect to the Grid?

All solar farms connect to a specific point on the electrical grid, the vast network of wires that connects every power generation plant to every home and business that consumes power. ...



How to Check If Your Solar Panels Are ...

If the inverter still isn't responding, try resetting it or look for any blown fuses that might need replacing to answer the question of how ...

How to Connect PV Solar to the Utility Grid: A ...

Solar energy is becoming increasingly popular as homeowners and businesses strive to reduce their energy costs and carbon footprint. ...



Solar Integration: Inverters and Grid Services Basics

If you have a household solar system, your inverter probably performs several



functions. In addition to converting your solar energy into AC power, it can monitor the system ...

Port Louis Harbour: A Strategic Hub for Solar Manufacturing

Together, Port Louis Harbour and the Mauritius Freeport offer a powerful, well-integrated logistics platform for solar module manufacturing. The combination of world-class ...



Solar Interconnection: How Solar Farms ...

Solar interconnection is critical for commercial solar projects to connect to the power grid and earn compensation for electricity generated ...

Understanding the Grid: A Comprehensive ...

Learn how the electrical grid operates, why it matters, and how staying

connected boosts savings and reliability with this guide from Blue ...

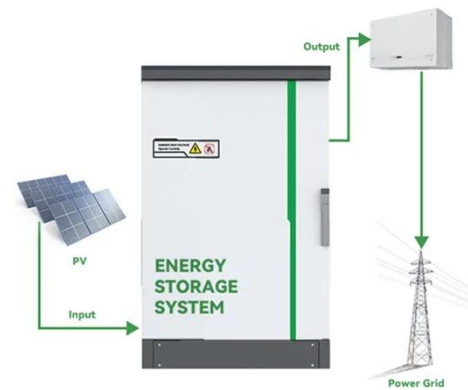

How to connect a PV solar system to the utility grid

The purpose of this article is to give you a basic understanding of the concepts and rules for connecting a solar panel system to the utility grid and the household electrical box or meter. ...

Grid-connected PV system: working principle

Grid-connected PV systems are installations in which surplus energy is sold and fed into the electricity grid. On the other hand, when the user needs electrical power from ...



How do solar power plants connect to the grid?

Solar power plants connect to the grid by converting DC power from panels into



synchronized AC power using inverters, stepping up voltage via transformers, and ensuring ...

How Does a Solar Farm Connect to the Power Grid?

The first step in connecting a solar farm to the power grid is through the use of inverters, which convert solar energy into usable power that can be used by the power grid. ...



The Point of Interconnection (POI) in Utility-Scale Solar Projects

In utility scale in solar projects, the POI is a point of interconnection for clean energy into the grid. A well-integrated POI means that the project is set to operate within the ...



Contact Us

For catalog requests, pricing, or partnerships, please contact:

BLINK SOLAR

Phone: +48-22-555-9876

Email: info@blinkartdesign.pl

Website: <https://blinkartdesign.pl>

Scan QR code to visit our website:

