

BLINK SOLAR

The power consumption of the solar inverter itself



Overview

In terms of power consumption, the solar inverter itself uses a small amount of electricity. Typically, it uses less than 1% of the total energy produced by the solar panels. What is solar inverter efficiency?

Solar inverter efficiency determines how well an inverter converts the DC electricity created by solar panels to AC electricity that can be used in our homes and by the grid. Inverters are an integral part of any solar installation. Without them, our installations would actually be useless, since we couldn't use the electricity they produced.

How much power does an inverter consume?

In the datasheet of the inverter it is written that the consumption of the inverter is: $< 0.24\%$ of $P_{ac,r}$. I really don't know what is $P_{ac,r}$. I found $P_{ac,r}$ that is 55 kW but I don't think that an inverter has a consumption of 13200 W. Is it possible?

I allegated the screenshot of the part of the datasheet where it is written.

How much power does a 500W inverter use?

The inverter itself uses about 30W running a 500W load. There are some times that there is no load. Does the inverter still consume the same amount of power then?

Or significantly less because it is proportional to the load?

It's hard to tell since my usage watt meters are downstream after the inverter. Thanks in advance.

How much power does a 120V inverter use?

All inverters providing ready-to-use 120VAC have an idle consumption. There is a cost to running the circuitry that generates the 120VAC and 60Hz frequency. My 4kW Victron is about 30W as well.

The power consumption of the solar inverter itself



Does a solar inverter use a lot of electricity

Solar inverters are crucial components of solar energy systems as they convert the direct current (DC) electricity produced by solar panels into alternating current (AC) electricity, ...

How Much Power Does a Solar Inverter Need

To know how much power a solar inverter can supply, you should know that inverters usually come in different sizes, such as 50 watts right up to 50,000 watts. There is a ...



Inverter Efficiency: Understanding How Much Power You're ...

Have you ever wondered how much power you're actually getting from your inverter? Many people think that once they connect their solar panels and batteries to an ...

How Much Electricity Does A PV Inverter Use?

Conclusion In conclusion, while it's difficult to pinpoint exactly how much electricity a PV inverter consumes, there are several factors that can impact its electricity consumption. In addition, ...



Frequently Asked Questions about Inverters

What is efficiency? An inverter uses a small amount of energy during the conversion process. The difference between the input power and the output power is expressed in percentages. The ...

solar energy

I want to calculate the consumption of a PV inverter connected to a 50 kW PV plant. In the datasheet of the inverter it is written that the consumption of the inverter is: < 0.24% of ...



What Is The Energy Consumption Of A Solar Inverter?



A solar inverter is a converter that converts or inverts the direct current (DC) energy produced by a solar panel, making it possible to power your home with solar energy.

Understanding Inverter Power Consumption: Do Inverters Use Power ...

In today's energy-conscious world, many homeowners and businesses are increasingly turning to energy-efficient solutions, and inverters have become an essential part ...

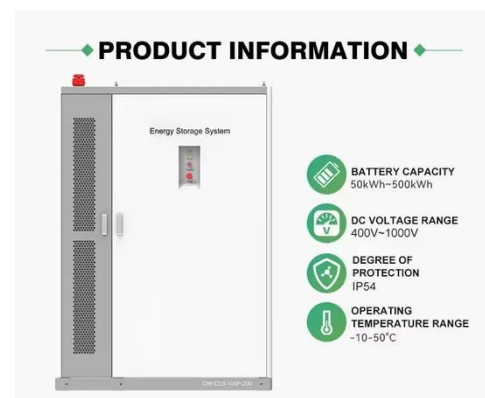

Parallel (Parallel operation up to 6 unit (only with battery connected))

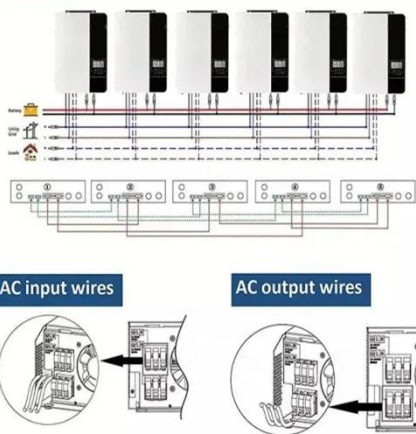

What is the standby power consumption of a solar inverter?

The standby power consumption of a solar inverter usually refers to the power consumed by the inverter itself when there is no load running. The amount of standby power consumption varies ...

How much power does an Inverter use just sitting there idling?

Hello, Quick question. I have a 24V 3000W pure sine wave inverter powering two 15A circuits. The inverter itself uses about 30W running a 500W load. There are some times ...



How much energy does an inverter consume?

An inverter itself consumes a small amount of energy, usually between 5 and 20 watts during operation. Thanks to the high efficiency of modern inverters, their own ...

How Much Power Does Solar Inverter Use and How to ...

Learn how much power a solar inverter uses and get practical tips on designing the ideal solar power project. From understanding inverter efficiency to system sizing, this ...



Does Inverter Increase Electricity Bill?

An inverter converts direct current (DC) from sources such as batteries or solar

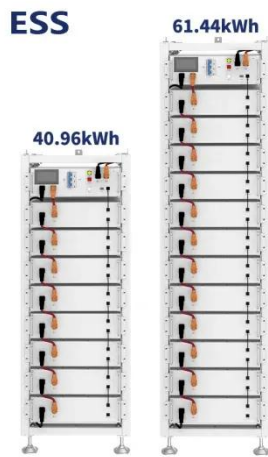

panels into alternating current (AC). Its primary function ...

Does a solar inverter use a lot of electricity

While it's true that some energy is required to power the inverter itself, the overall yield of energy generated by your solar system typically far outweighs this minor consumption, ...

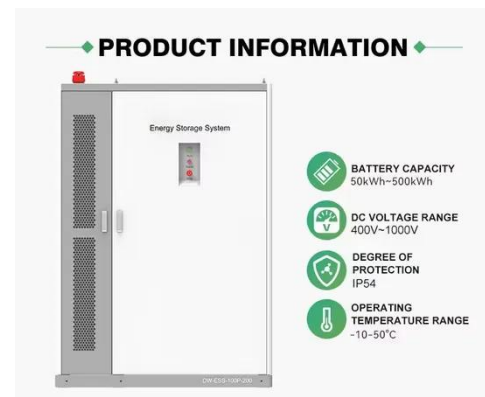

The Solar Lab

Since power stations store energy in DC, using DC appliances eliminates the need for inverter conversion, which means practically zero idle consumption losses from the inverter.



Contact Us

For catalog requests, pricing, or partnerships, please contact:

BLINK SOLAR

Phone: +48-22-555-9876

Email: info@blinkartdesign.pl

Website: <https://blinkartdesign.pl>

Scan QR code to visit our website:

